

ACCESSORIES

PLASTIC ENCLOSURES

Description: M40 cable gland nut

Reference:
92585

Description:

Accessory type:	NUTS
Series compatibility:	PRYMA - STAR - ECOLOGY
Product compatibility:	
Dimensions:	M40
Materials:	Polyamide, fibre reinforced
Thickness:	
Finish:	
Colour:	RAL 7035
Degree of protection:	
Modules:	
Max. Load:	
MOQ:	10
Supply:	

Codes:

EAN:	8431044925851
Customs tariff number:	85.38.10.00
ETIM 8.0:	EC000940

Technical data:

D=1,5
TL=7 mm
SW=50 mm
E=55 mm

Features:

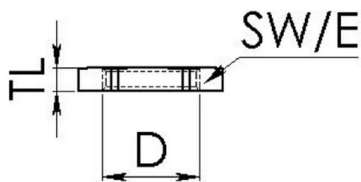

PRODUCT END OF LIFE:

IDE-ELECTRIC, S.L.- Leonardo da Vinci, 2.- Pol.Ind.- Los Huertos.- 50800 Zuera (Zaragoza).- SPAIN -- +34 976451080 -- ide@ide.es -- www.ide.es

SUSTAINABILITY:

It does not require specific recycling operations.

RoHS - REACH