

ACCESSORIES

PLASTIC ENCLOSURES

Description: M32 cable gland nut

Reference:
92583

Description:

Accessory type:	NUTS
For the following cabinets:	PRYMA - STAR - ECOLOGY
Dimensions:	M32
Materials:	Polyamide, fibre reinforced. RAL 7035
Packing units:	1
Supply:	10

Codes:

EAN:	8431044089683
Customs tariff number:	85.38.10.00
ETIM 6.0:	EC000940

Technical data:

D=1,5
TL=6 mm
SW=40 mm
E=45 mm

Features:

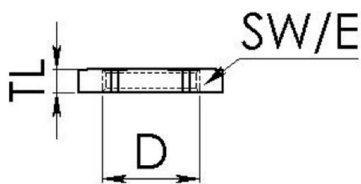

PRODUCT END OF LIFE:

It does not require specific recycling operations.

SUSTAINABILITY:

RoHS - REACH