



IP44 LOW VOLTAGE

50/60 Hz industrial plugs and sockets

The Mundial series is a set of power sockets for industrial uses. They are manufactured in accordance with the most demanding national and international standards so they can be distributed and installed in all markets. These parts undergo rigorous testing, thus guaranteeing all the required degrees of protection.

The sockets and plugs of this family are manufactured with high-durability halogen-free plastics and are available in a range of from 10 to 125 Amperes and from 24 to 500 Volts. Their ergonomic design greatly facilitates cable connection and installation.

They are intended for installation in places requiring power points for fixed machinery, portable tools or auxiliary electrical equipment. Their sphere of application therefore includes industrial premises and workshops, warehouses and depot areas, building sites, etc.



MUNDIAL Technical Specifications

- **Degree of protection:**
Schuko-type: IP44 / IP54 / IP67 / IP68.
Low voltage: IP44 / IP66 / IP67.
Interlocking: IP44 / IP54 / IP67.
Extra low voltage: IP44.
- **Resistance to impact:** IK08.
- **Glow wire resistance:** 960 °C.
- **Ball pressure test:** 125 °C.
- **Ambient temperature range:** -25 °C / +40 °C.

MUNDIAL Certifications

Compliant with the Low Voltage Directive 2014/35/EU.
Standards: UNE-EN 60309-1, UNE-EN 60309-2 and DIN VDE 0620-1 and IEC 60884-1 standards for Schuko-type sockets.

LOW VOLTAGE

50/60 Hz industrial plugs and sockets

LOW VOLTAGE PLUGS AND SOCKETS

IP44 product series

- Wander sockets.
- Straight flush-fit sockets.
- Sloping flush-fit sockets.
- Wall sockets.
- Wander plugs.
- Straight flush-fit plugs.
- Wall plugs.
- Phase inverters.

- Current: 16 A – 32 A.
- Voltage: 110V – 220V – 380V – 500V.
- Poles: 2P+E – 3P+E – 3P+N+E.
- Time code: 2h – 4h – 6h – 7h – 9h – 10h.



IP44 WANDER PLUG



IP44 WALL SOCKET

Material

- Plastic parts: Polyamide 6.
- Contacts: Copper-zinc alloy.
- Halogen-free plastic materials.

Main characteristics of the plastic material:

- Excellent resistance to impact.
- High thermal stability.
- Very good insulating qualities.
- High disruptive force.
- High resistance to extreme environmental agents.
- High resistance to chemical products and agents.

Main characteristics of the contacts:

- High-capacity electrical conduction: 15 mm²/(Ohm mm²).
- High corrosion resistance in industrial areas.
- Possibility of requesting nickel-plated contacts to increase resistance in marine, steamy environments, etc. (Add /NC to the reference).

Supply

Supplied in an individual box per packaging multiple.



Wander socket and plug body

- They feature an ergonomic design that makes it extremely easy for the installer to hold and handle them.
- The cable hose is secured by means of a cable gland system that guarantees total protection against the entry of water and solid bodies.
- Clipping system opening and closing, with a tool required to access live parts, in compliance with regulations.
- Easy access to cable connection thanks to screws on the side facing in the same direction.

Ergonomic design that facilitates holding and handling

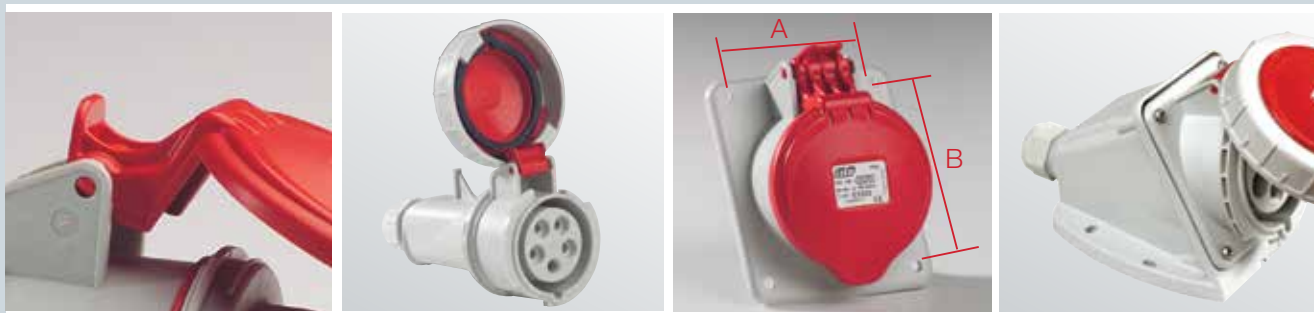

Cover

- It features geometric forms that provide it with excellent rigidity and resistance to knocks and handling. There are three recesses at the top which become connection ribs with the opening and rotation tab.
- 180° cover opening and rotation, thus providing total and unlimited opening.
- The IP67 sockets and plugs have a ring that guarantees their degree of protection.

Shield for flush-fit sockets

- Four unique shield sizes. Two for 16 A and 32 A sockets and two for 63 A and 125 A sockets.

Wall sockets

- The IP44 wall sockets have a threaded cap and the IP67 sockets a cable gland to guarantee their degree of protection.
- They have threaded holes for wall-mounting that facilitate installation and levelling.

LOW VOLTAGE

50/60 Hz industrial plugs and sockets

IP44 low voltage sockets



Current	Poles	Voltage (V)	Time code	Straight flush-fit sockets				Sloping flush-fit sockets				Wall sockets				Wander sockets			
				Reference No.	Reference No.	Reference No.	Reference No.	Reference No.	Reference No.	Reference No.	Reference No.	Reference No.	Reference No.	Reference No.	Reference No.				
16A	2P+E	>50(301-500Hz)	2	█	-	07301	07321	07201											
		100/130	4	█	01311	01301	01321	01201											
		200/250	6	█	02311	02301	02321	02201											
		480/500	7	█	-	05301	05321	05201											
	3P+E	380/415	9	█	03311	03301	03321	03201											
		>50(301-500Hz)	2	█	-	07302	07322	07202											
		100/130	4	█	01312	01302	01322	01202											
		380/415	6	█	03312	03302	03322	03202											
	3P+N+E	480/500	7	█	05312	05302	05322	05202											
		200/250	9	█	02312	02302	02322	02202											
		>50(100-300Hz)	10	█	-	07382	07352	07282											
		>50(301-500Hz)	2	█	-	07303	07323	07203											
	3P+N+E	57/100 75/130	4	█	01313	01303	01323	01203											
		200/346 240/415	6	█	03313	03303	03323	03203											
277/480 288/500		7	█	05313	05303	05323	05203												
120/208 144/250		9	█	02313	02303	02323	02203												
>50(301-500Hz)		2	█	-	07304	07324	07204												
100/130		4	█	01314	01304	01324	01204												
32A	2P+E	200/250	6	█	02314	02304	02324	02204											
		480/500	7	█	-	05304	05324	05204											
		380/415	9	█	03314	03304	03324	03204											
		>50(301-500Hz)	2	█	-	07305	07325	07205											
	3P+E	100/130	4	█	01315	01305	01325	01205											
		380/415	6	█	03315	03305	03325	03205											
		480/500	7	█	05315	05305	05325	05205											
		200/250	9	█	02315	02305	02325	02205											
	3P+N+E	>50(100-300Hz)	10	█	-	07385	07395	07285											
		>50(301-500Hz)	2	█	-	07306	07326	07206											
		57/100 75/130	4	█	01316	01306	01326	01206											
		200/346 240/415	6	█	03316	03306	03326	03206											
		277/480 288/500	7	█	05316	05306	05326	05206											
		120/208 144/250	9	█	02316	02306	02326	02206											

Available with nickel-plated contacts for marine environments. Ask us about price and delivery terms.



IP44 low voltage plugs



Current	Poles	Voltage (V)	Time code	Wander plugs	Straight flush-fit plugs	Wall plugs	
				Reference No.	Reference No.	Reference No.	
16A	2P+E	>50(301-500Hz)	2		07101	-	-
		100/130	4		01101	01111	01121
		200/250	6		02101	02111	02121
		480/500	7		05101	-	-
		380/415	9		03101	03111	03121
	3P+E	>50(301-500Hz)	2		07102	-	-
		100/130	4		01102	01112	01122
		380/415	6		03102	03112	03122
		480/500	7		05102	05112	05122
		200/250	9		02102	02112	02122
	3P+N+E	>50(100-300Hz)	10		07182	-	-
		>50(301-500Hz)	2		07103	-	-
		57/100 75/130	4		01103	01113	01123
		200/346 240/415	6		03103	03113	03123
277/480 288/500		7		05103	05113	05123	
120/208 144/250	9		02103	02113	02123		
32A	2P+E	>50(301-500Hz)	2		07104	-	-
		100/130	4		01104	01114	01124
		200/250	6		02104	02114	02124
		480/500	7		05104	-	-
		380/415	9		03104	03114	03124
	3P+E	>50(301-500Hz)	2		07105	-	-
		100/130	4		01105	01115	01125
		380/415	6		03105	03115	03125
		480/500	7		05105	05115	05125
		200/250	9		02105	02115	02125
	3P+N+E	>50(100-300Hz)	10		07185	-	-
		>50(301-500Hz)	2		07106	-	-
		57/100 75/130	4		01106	01116	01126
		200/346 240/415	6		03106	03116	03126
277/480 288/500	7		05106	05116	05126		
120/208 144/250	9		02106	02116	02126		

IP44-IP67 phase inverter connectors



IP44 phase inverter

IP67 phase inverter

Current	Poles	Voltage (V)	Time code	Reference No.	Reference No.	
16A	2P+E	200/250	9		08509	08510
	3P+E	380/415	6		08501	08505
	3P+N+E	200/346 - 240/415	6		08502	08506
32A	2P+E	200/250	9		08511	08512
	3P+E	380/415	6		08503	08507
	3P+N+E	200/346 - 240/415	6		08504	08508

LOW VOLTAGE

50/60 Hz industrial plugs and sockets dimensions

DIMENSIONS

IP44 straight flush-fit sockets

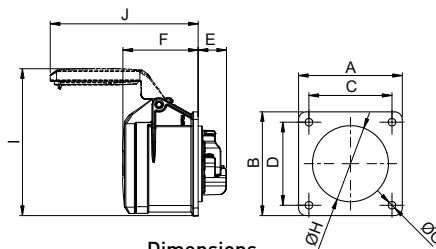

Current	Poles	Dimensions							
		(AxB)	(CxD)	E	F	G	H	I	J
16A	2P+E	70x70	56x56	21	55	5,5	43	87	101
	3P+E	70x70	56x56	21	55	5,5	45	101	101
	3P+N+E	70x70	56x56	21	55	5,5	55	105	107
32A	2P+E	70x70	56x56	23	67	5,5	55	112	122
	3P+E	70x70	56x56	23	67	5,5	55	112	122
	3P+N+E	70x70	56x56	23	67	5,5	58	108	136

IP44 sloping flush-fit sockets

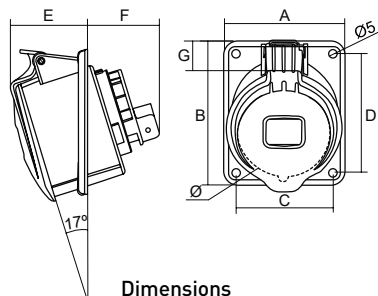

Current	Poles	Dimensions							
		A	B	C	D	E	F	Ø	G
16A	2P+E	66	83	50	65	43	43	53	17
	3P+E	66	83	50	65	43	43	60	14
	3P+N+E	80	96	64	79	43	47	66	15
32A	2P+E	80	96	64	79	50	51	68	14
	3P+E	80	96	64	79	50	51	68	14
	3P+N+E	80	96	64	79	50	51	74	11

IP44 wall sockets

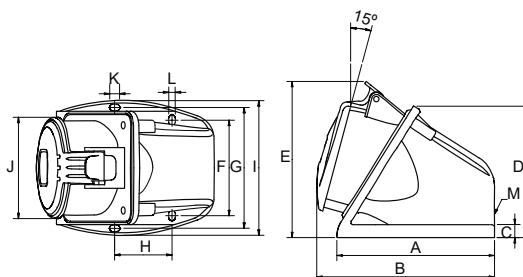

Current	Poles	Dimensions												
		A	B	C	D	E	F	G	H	I	J	K	L	M
16A	2P+E	100	109	10	88	98	53.6	76.6	40	87	55.5	8	5	M25x1.5
	3P+E	100	109	10	88	103	53.6	76.6	40	87	61.8	8	5	M25x1.5
	3P+N+E	118	127	10	99	117	71.6	90.6	43	101	70	8	5	M25x1.5
32A	2P+E	118	132	10	99	117	71.6	90.6	43	101	70	8	5	M25x1.5
	3P+E	118	132	10	99	117	71.6	90.6	43	101	70	8	5	M25x1.5
	3P+N+E	118	132	10	99	120	71.6	90.6	43	101	76.7	8	5	M25x1.5

IP44 wander sockets

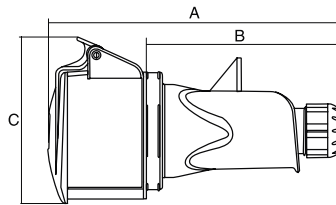

Current	Poles	Dimensions		
		A	B	C
16A	2P+E	151	96	82
	3P+E	156	106	86
	3P+N+E	161	111	98
32A	2P+E	171	111	98
	3P+E	171	111	98
	3P+N+E	178	118	102

IP44 wander plugs

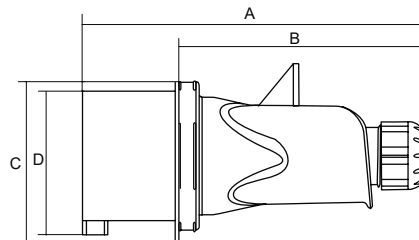

Current	Poles	Dimensions			
		A	B	C	D
16A	2P+E	134	96	55	54
	3P+E	144	106	61	58
	3P+N+E	149	111	69	66
32A	2P+E	156	111	72	66
	3P+E	156	111	72	66
	3P+N+E	163	118	78	72

IP44 straight flush-fit plugs

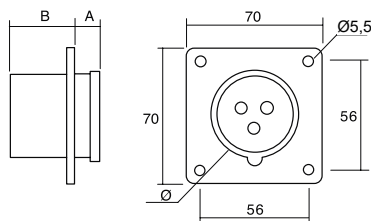

Current	Poles	Dimensions		
		A	B	Ø
16A	2P+E	21	42	43
	3P+E	21	42	45
	3P+N+E	20	42	55
32A	2P+E	21	51	55
	3P+E	21	51	55
	3P+N+E	21	51	55

IP44 wall plugs

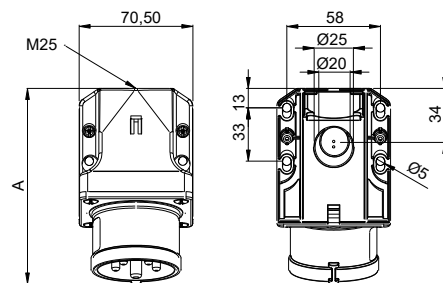

B = Height. 15° = Slope

Current	Poles	Dimensions		
		A	B	M
16A	2P+E	120	76	25
	3P+E	121	76	25
	3P+N+E	122	79	25
32A	2P+E	131	82	25
	3P+E	131	82	25
	3P+N+E	132	85	25



Head Office

Leonardo da Vinci 2
Pol. Ind. Los Huertos
E-50800 Zuera
Zaragoza (Spain)

Warehouse and logistics

Guttemberg 48
Pol. Ind. Los Huertos
E-50800 Zuera
Zaragoza (Spain)

Phone: +34 976 451 080**E-mail:** ide@ide.es**Web:** www.ide.es

