



ARGENTA

IP66 Steel wall-mounting cabinets

The ARGENTA Series is a group of steel enclosures used to house electrical or electronic switchgear, control gear and equipment necessary to supply, distribute and transform electricity in industrial installations.

This series comprises an extensive range of standard models made with premium-quality materials in cold-rolled steel plate.

The design and manufacture of this product line is flexible and can be customized for settings that require specific dimensions depending on user requirements and installations.

The full range is accompanied by a set of complementary accessories: mounting plates, inner doors, canopies, eyebolts, ventilation systems, chassis, etc.



ARGENTA Technical Specifications (Rolled steel)

- **Degree of protection:**
 - Single-door cabinets: IP66 / NEMA 1, 12, 4.
 - Double-door cabinets: IP55 / NEMA 1, 12.
- **Resistance to impact:**
 - Opaque door: IK10.
 - Transparent door: IK09.
- **Ambient temperature range:** -25 °C / +60 °C.
- **Maximum rated operating voltage:** 1000 V AC / 1500 V DC.

ARGENTA Certifications (Rolled steel)

Compliant with the Low Voltage Directive 2014/35/EU.
Standards: UNE-EN 62208 and UNE-EN 61439-1 (as applicable).
UL508A and Gost-R certificates.
Bureau Veritas according to UNE-EN 62208 standards.
Certificate for boats.
VDE Certificate available for single-door cabinets.

ARGENTA

IP66 rolled steel wall-mounting cabinets



Product series (Rolled steel)

Standard

- Opaque door cabinets with mounting plate.
- Transparent single-door cabinets with mounting plate (add GNT to the reference).

To order

- Opaque door cabinets without mounting plate (add /SP to the standard reference).
- Special cabinets, dimensions, cut-outs, colours, etc.

Supply

- Supplied in individual packaging containing cabinet, plate and accessory bag.

Plain mounting plate

- For cabinets with a height of up to 700 mm they are supplied unassembled inside the packaging.
- For cabinets with a height of up to 800 mm and above they are supplied assembled.

Accessory bag:

- 4 watertight caps (if the wall-mounting cut-out holes are not used).
- Nut and washer kit for securing the earth wire.
- Plate height adjusters, nuts, washers and drainage caps.
- Key.
- Cable entry lid and fixing screws.
- Assembly instructions.

Intended for industrial facilities, wherever a high degree of protection and safety is required

Material

- Cold-rolled steel EN 10130+A1.
- Injected polyurethane sealing gasket.

Finish

- Coated with primer and hardened RAL 7035 embossed polyester paint, with UV protection.

Protection

- Corrosion resistance according to the UNE-EN 62208 standard. For outdoor installations the use of a canopy is recommended. The effect of corrosion must be taken into consideration.

Standard painting cycle

- **Degreasing:** Removal of remains of contaminants by means of a neutral stripper and tensoactive concentrate.
- **Rinsing:** Two rinses, the first one with mains water and the second one with demineralised water.
- **Passivation:** Thin-coat conversion agent.
- **Drying:** With hot air (in a tunnel at 100 °C).
- **Primer painting:** Application of a first layer of antioxidant protection primer paint.
- **First firing:** Furnace polymerisation adherence at 170 °C for 10 min.
- **Painting:** Coated with hardened RAL 7035 polyester paint.
- **Firing:** Furnace polymerisation adherence at 180 °C for 15-20 min.



Enclosure

- Manufactured in cold-rolled steel from a single cross-shaped part.
- Totally reversible cabinet.
- Sheet thickness:
 - 1.2 mm for cabinets from 250x200 to 600x500.
 - 1.5 mm for cabinets from 600x600 to 1400x1000 mm.
- Wall-mounting by means of four Ø9 mm cut-out holes.
- Wall-mounting support leaving a gap of 11 mm (supplied as an accessory).
- Four M8x25 bolts at the back of the cabinet for securing plates, adjustment elements or chassis.
- M6x10 earth bolt located on the cabinet wall for joining enclosure and door by means of earth wire.
- 2-mm thick cable entry lid with sealing gasket to guarantee IP protection.
- Double fold to prevent water from entering the cabinet.
- Drainage hole at the base of the cabinet to prevent condensation on the inside.

Door

- Possibility of opaque or transparent door with 110° reversible opening.
- Possibility of double door from 1000-mm width.
- Concealed and removal hinges with quick-assembly and disassembly pins.
- Sheet thickness on opaque doors:
 - 1.2 mm for cabinets from 250x200 to 600x400 mm.
 - 1.5 mm for cabinets from 600x500 to 800x1000 mm.
 - 2 mm for cabinets from 800x1200 to 1400x1000 mm.
- Transparent glass door:
 - 4-mm thick tempered glass in cabinets from 300x400 to 1200x1200 mm.
 - 3-mm thick Polycarbonate in cabinets from 250x200 to 300x300 mm.
- Injected polyurethane sealing gasket to guarantee IP protection.
- Welded reinforcement profiles with cut-out holes with a separation of 25 mm for fitting accessories.
- Door centring device included in cabinets with a height of 600 mm and greater.



Locking

- Standard 5-mm double-bit lock plus key.
- Three-point rod lock for cabinets with a height of 1000 mm or greater.
- Other types of locks supplied as accessories.

Mounting plate

- Flat mounting plate included in all cabinet references.
- Made from galvanised sheet steel with a thickness of 2 mm.
- For cabinets with a height of 600 mm or greater, the plates have folds on the sides to provide greater rigidity.

ARGENTA

IP66 rolled steel wall-mounting cabinets



Opaque door cabinets



Opaque double door cabinets



Transparent door cabinet

IP66 opaque cabinets. Rolled steel

Reference No.	Dim. Cabinet			Cable entry DXE	Dim. plate			Sheet thickness ENCL. DOOR	Door type	No. locks	Reinf. prof.	Door with transparent panel		Weight kg	Power dissipation according to temperature increase °C P(W)				
	A	B	C		F	G	126					82	20		25	30	35	40	
GN252015	250	200	150	65x120	220	150	1.2	1.2	Single	1	1	126	82	3.7	19.75	24.68	29.62	34.55	39.49
GN252515	250	250	150	65x120	220	200	1.2	1.2	Single	1	1	146	98	4.3	22.83	28.53	34.24	39.94	45.65
GN302015	300	200	150	65x120	270	150	1.2	1.2	Single	1	1	176	82	4.2	22.77	28.46	34.16	39.85	45.54
GN302515	300	250	150	65x120	270	200	1.2	1.2	Single	1	1	196	98	5.0	26.24	32.79	39.35	45.91	52.47
GN302520	300	250	200	65x120	270	200	1.2	1.2	Single	1	1	196	98	5.6	31.13	38.91	46.70	54.48	62.26
GN303015	300	300	150	65x185	270	250	1.2	1.2	Single	1	2	196	148	5.8	29.70	37.13	44.55	51.98	59.40
GN303020	300	300	200	125x215	270	250	1.2	1.2	Single	1	2	196	148	6.7	34.98	43.73	52.47	61.22	69.96
GN304015	300	400	150	65x285	270	350	1.2	1.2	Single	1	2	196	248	7.3	36.63	45.79	54.95	64.10	73.26
GN304020	300	400	200	125x285	270	350	1.2	1.2	Single	1	2	196	248	8.2	42.68	53.35	64.02	74.69	85.36
GN403015	400	300	150	65x185	370	250	1.2	1.2	Single	1	2	296	148	7.2	37.29	46.61	55.94	65.26	74.58
GN403020	400	300	200	125x215	370	250	1.2	1.2	Single	1	2	296	148	8.1	43.56	54.45	65.34	76.23	87.12
GN404015	400	400	150	65x285	370	350	1.2	1.2	Single	1	2	296	248	9.1	45.76	57.20	68.64	80.08	91.52
GN404020	400	400	200	125x285	370	350	1.2	1.2	Single	1	2	296	248	10.1	52.80	66.00	79.20	92.40	105.60
GN404025	400	400	250	125x285	370	350	1.2	1.2	Single	1	2	296	248	11.1	59.84	74.80	89.76	104.72	119.68
GN406020	400	600	200	125x485	370	550	1.2	1.2	Single	1	2	297	449	14.9	71.28	89.10	106.92	124.74	142.56
GN406025	400	600	250	125x485	370	550	1.2	1.2	Single	1	2	297	449	15.9	79.86	99.83	119.79	139.76	159.72
GN406030	400	600	300	125x485	370	550	1.2	1.2	Single	1	2	297	449	16.9	88.44	110.55	132.66	154.77	176.88
GN503015	500	300	150	65x185	470	250	1.2	1.2	Single	2	2	396	148	8.8	44.88	56.10	67.32	78.54	89.76
GN503020	500	300	200	125x215	470	250	1.2	1.2	Single	2	2	396	148	9.7	52.14	65.18	78.21	91.25	104.28
GN503025	500	300	250	125x215	470	250	1.2	1.2	Single	2	2	396	148	10.7	59.40	74.25	89.10	103.95	118.80
GN504015	500	400	150	65x285	470	350	1.2	1.2	Single	2	2	396	248	11.0	54.89	68.61	82.34	96.06	109.78
GN504020	500	400	200	125x285	470	350	1.2	1.2	Single	2	2	396	248	12.1	62.92	78.65	94.38	110.11	125.84
GN504025	500	400	250	125x285	470	350	1.2	1.2	Single	2	2	396	248	13.0	70.95	88.69	106.43	124.16	141.90
GN504030	500	400	300	125x285	470	350	1.2	1.2	Single	2	2	396	248	14.1	78.98	98.73	118.47	138.22	157.96
GN505015	500	500	150	65x285	470	450	1.2	1.2	Single	2	2	396	348	13.2	64.90	81.13	97.35	113.58	129.80
GN505020	500	500	200	125x385	470	450	1.2	1.2	Single	2	2	396	348	14.5	73.70	92.13	110.55	128.98	147.40
GN505025	500	500	250	125x385	470	450	1.2	1.2	Single	2	2	396	348	15.6	82.50	103.13	123.75	144.38	165.00
GN505030	500	500	300	125x385	470	450	1.2	1.2	Single	2	2	396	348	16.6	91.30	114.13	136.95	159.78	182.60
GN507020	500	700	200	125x485	470	650	1.5	1.5	Single	2	2	396	549	21.9	97.02	121.28	145.53	169.79	194.04
GN508025	500	800	250	125x685	470	750	1.5	1.5	Single	2	2	396	649	26.7	117.20	146.40	175.70	205.00	234.30
GN508030	500	800	300	125x685	470	750	1.5	1.5	Single	2	2	396	649	28.3	128.30	160.30	192.40	224.50	256.50
GN5010025/PD	500	1000	250	125x885	470	950	1.5	1.5	Double	3P	2	-	-	32.9	140.30	175.30	210.40	245.40	280.50
GN5010030/PD	500	1000	300	125x885	470	950	1.5	1.5	Double	3P	2	-	-	35.5	152.90	191.10	229.40	267.60	305.80
GN604015	600	400	150	65x285	570	350	1.2	1.2	Single	2	2	496	248	12.8	64.02	80.03	96.03	112.04	128.04
GN604020	600	400	200	125x285	570	350	1.2	1.2	Single	2	2	496	248	14.1	73.04	91.30	109.56	127.82	146.08

**IP66 opaque cabinets. Rolled steel**

Reference No.	Dim. Cabinet			Cable entry	Dim. plate			Sheet thickness	Door type	No. locks	Reinf. prof.	Door with transparent panel		Weight kg	Power dissipation according to temperature increase °C P(W)				
	A	B	C		DXE	F	G					ENCL. DOOR	20		25	30	35	40	
GN604025	600	400	250	125x285	570	350	1,2	1,2	Single	2	2	496	248	15,1	82.06	102.58	123.09	143.61	164.12
GN604030	600	400	300	125x285	570	350	1,2	1,2	Single	2	2	496	248	16,1	91.08	113.85	136.62	159.39	182.16
GN605015	600	500	150	65x285	570	450	1,2	1,5	Single	2	2	497	349	16,1	75.57	94.46	113.36	132.25	151.14
GN605020	600	500	200	125x385	570	450	1,2	1,5	Single	2	2	497	349	17,6	85.36	106.70	128.04	149.38	170.72
GN605025	600	500	250	125x385	570	450	1,2	1,5	Single	2	2	497	349	18,7	95.15	118.94	142.73	166.51	190.30
GN605030	600	500	300	125x385	570	450	1,2	1,5	Single	2	2	497	349	19,9	104.94	131.18	157.41	183.65	209.88
GN606020	600	600	200	125x485	570	550	1,5	1,5	Single	2	2	497	449	22,4	97.68	122.10	146.52	170.94	195.36
GN606025	600	600	250	125x485	570	550	1,5	1,5	Single	2	2	497	449	23,9	108.24	135.30	162.36	189.42	216.48
GN606030	600	600	300	125x485	570	550	1,5	1,5	Single	2	2	497	449	25,4	118.80	148.50	178.20	207.90	237.60
GN606040	600	600	400	125x485	570	550	1,5	1,5	Single	2	2	497	449	28,8	139.92	174.90	209.88	244.86	279.84
GN608025	600	800	250	125x685	570	750	1,5	1,5	Single	2	2	497	649	30,9	134.40	168.00	201.60	235.20	268.80
GN608030	600	800	300	125x685	570	750	1,5	1,5	Single	2	2	497	649	32,7	146.52	183.15	219.78	256.41	293.04
GN6012025/PD	600	1200	250	2x(125x485)	570	1150	1,5	1,5	Double	3P	2	-	-	44,7	186.80	233.50	280.20	326.90	373.60
GN6012030/PD	600	1200	300	2x(125x485)	570	1150	1,5	1,5	Double	3P	2	-	-	47,6	202.00	252.50	302.90	353.40	403.90
GN705015	700	500	150	65x285	670	450	1,5	1,5	Single	2	2	597	349	20,0	86.24	107.80	129.36	150.92	172.48
GN705020	700	500	200	125x385	670	450	1,5	1,5	Single	2	2	597	349	21,8	97.02	121.28	145.53	169.79	194.04
GN705025	700	500	250	125x385	670	450	1,5	1,5	Single	2	2	597	349	23,3	107.80	134.75	161.70	188.65	215.60
GN705030	700	500	300	125x385	670	450	1,5	1,5	Single	2	2	597	349	25,0	118.60	148.20	177.90	207.50	237.20
GN804020	800	400	200	125x285	770	350	1,5	1,5	Single	2	2	697	249	20,9	93.28	116.60	139.92	163.24	186.56
GN804025	800	400	250	125x285	770	350	1,5	1,5	Single	2	2	697	249	22,5	104.28	130.35	156.42	182.49	208.56
GN804030	800	400	300	125x285	770	350	1,5	1,5	Single	2	2	697	249	23,8	115.28	144.10	172.92	201.74	230.56
GN806020	800	600	200	125x485	770	550	1,5	1,5	Single	2	2	697	449	28,9	124.08	155.10	186.12	217.14	248.16
GN806025	800	600	250	125x485	770	550	1,5	1,5	Single	2	2	697	449	30,8	136.62	170.78	204.93	239.09	273.24
GN806030	800	600	300	125x485	770	550	1,5	1,5	Single	2	2	697	449	32,5	149.16	186.45	223.74	261.03	298.32
GN806040	800	600	400	125x485	770	550	1,5	1,5	Single	2	2	697	449	36,1	174.24	217.80	261.36	304.92	348.48
GN808020	800	800	200	125x685	770	750	1,5	1,5	Single	2	2	697	649	37,0	154.88	193.60	232.32	271.04	309.76
GN808025	800	800	250	125x685	770	750	1,5	1,5	Single	2	2	697	649	39,0	168.96	211.20	253.44	295.68	337.92
GN808030	800	800	300	125x685	770	750	1,5	1,5	Single	2	2	697	649	41,1	183.04	228.80	274.56	320.32	366.08
GN808040	800	800	400	125x685	770	750	1,5	1,5	Single	2	2	697	649	45,1	211.20	264.00	316.80	369.60	422.40
GN8010020/PD	800	1000	200	125x885	770	950	1,5	1,5	Double	3P	4	-	-	46,3	185.68	232.10	278.52	324.94	371.36
GN8010030	800	1000	300	125x885	770	950	1,5	1,5	Single	2	4	697	849	50,1	216.92	271.15	325.38	379.61	433.84
GN8010030/PD	800	1000	300	125x885	770	950	1,5	1,5	Double	3P	4	-	-	51,1	216.92	271.15	325.38	379.61	433.84
GN8010040/PD	800	1000	400	125x885	770	950	1,5	1,5	Double	3P	4	-	-	55,8	248.16	310.20	372.24	434.28	496.32
GN8012030/PD	800	1200	300	2x(125x485)	770	1150	1,5	1,5	Double	3P	4	-	-	59,6	250.80	313.50	376.20	438.90	501.60
GN8012040/PD	800	1200	400	2x(125x485)	770	1150	1,5	1,5	Double	3P	4	-	-	64,9	285.12	356.40	427.68	498.96	570.24
GN1006025	800	600	250	125x485	970	550	1,5	2	Single	3P	2	897	419	40,1	193.38	241.73	290.07	338.42	386.76
GN1006030	1000	600	300	125x485	970	550	1,5	2	Single	3P	2	897	419	42,2	209.88	262.35	314.82	367.29	419.76
GN1006040	1000	600	400	125x485	970	550	1,5	2	Single	3P	2	897	419	46,2	242.88	303.60	364.32	425.04	485.76
GN1008025	1000	800	250	125x685	970	750	1,5	2	Single	3P	2	897	619	50,8					
GN1008030	1000	800	300	125x685	970	750	1,5	2	Single	3P	2	897	619	53,1	256.08	320.10	384.12	448.14	512.16
GN1008040	1000	800	400	125x685	970	750	1,5	2	Single	3P	2	897	619	57,8	292.16	365.20	438.24	511.28	584.32
GN10010030	1000	1000	300	125x885	970	950	1,5	1,5	Single	3P	4	897	819	60,6	259.60	324.50	389.40	454.30	519.20
GN10010030/PD	1000	1000	300	125x885	970	950	1,5	2	Double	3P	4	-	-	65,7	259.60	324.50	389.40	454.30	519.20
GN10010040/PD	1000	1000	400	125x885	970	950	1,5	2	Double	3P	4	-	-	70,9	294.80	368.50	442.20	515.90	589.60
GN10012030/PD	1000	1200	300	2x(125x485)	970	1150	1,5	2	Double	3P	4	-	-	76,7	299.64	374.55	449.46	524.37	599.28
GN10012040/PD	1000	1200	400	2x(125x485)	970	1150	1,5	2	Double	3P	4	-	-	82,4	337.92	422.40	506.88	591.36	675.84
GN1206025	1200	600	250	125x485	1170	550	1,5	2	Single	3P	2	1097	419	47,1	193.38	241.73	290.07	338.42	386.76
GN1206030	1200	600	300	125x485	1170	550	1,5	2	Single	3P	2	1097	419	49,4	209.88	262.35	314.82	367.29	419.76
GN1206040	1200	600	400	125x485	1170	550	1,5	2	Single	3P	2	1097	419	53,8	242.88	303.60	364.32	425.04	485.76
GN1208030	1200	800	300	125x685	1170	750	1,5	2	Single	3P	2	1097	619	62,1	256.08	320.10	384.12	448.14	512.16
GN1208040	1200	800	400	125x685	1170	750	1,5	2	Single	3P	2	1097	619	67,5	292.16	365.20	438.24	511.28	584.32
GN1209030	1200	900	285	125x685	1170	850	1,5	2	Single	3P	2	1097	719	67,4	271.66	339.57	407.48	475.40	543.31
GN12010030	1200	1000	300	125x885	1170	950	1,5	1,5	Single	3P	4	1097	819	70,7	302.28	377.85	453.42	528.99	604.56

CONTINUED ON NEXT PAGE.

ARGENTA

IP66 rolled steel wall-mounting cabinets

IP66 opaque cabinets. Rolled steel

Reference No.	Dim. Cabinet			Cable entry	Dim. plate			Sheet thickness	Door type	No. locks	Reinf. prof.	Door with transparent panel		Weight kg	Power dissipation according to temperature increase °C P(W)				
	A	B	C		DXE	F	G					ENCL. DOOR	-		-	20	25	30	35
GN12010030/PD	1200	1000	300	125x885	1170	950	1,5	2	Double	3P	4	-	-	76,8	302.28	377.85	453.42	528.99	604.56
GN12010040/PD	1200	1000	400	125x885	1170	950	1,5	2	Double	3P	4	-	-	82,6	341.44	426.80	512.16	597.52	682.88
GN12012025	1200	1200	250	2x(125x485)	1170	1150	1,5	1,5	Single	3P	4	1097	1019	79,6	327.36	409.20	491.04	572.88	654.72
GN12012025/PD	1200	1200	250	2x(125x485)	1170	1150	1,5	2	Double	3P	4	-	-	86,5	327.36	409.20	491.04	572.88	654.72
GN12012030/PD	1200	1200	300	2x(125x485)	1170	1150	1,5	2	Double	3P	4	-	-	89,3	348.48	435.60	522.72	609.84	696.96
GN12012040/PD	1200	1200	400	2x(125x485)	1170	1150	1,5	2	Double	3P	4	-	-	95,9	390.72	488.40	586.08	683.76	781.44
GN1406030	1400	600	300	125x485	1370	550	1,5	1,5	Single	3P	2	1297	419	53,0	240.20	300.30	360.40	420.40	480.50
GN1406040	1400	600	400	125x485	1370	550	1,5	1,5	Single	3P	2	1297	419	58,3	277.20	346.50	415.80	485.10	554.40
GN1408030	1400	800	300	125x685	1370	750	1,5	1,5	Single	3P	2	1297	619	66,4	292.60	365.80	438.90	512.10	585.20
GN1408040	1400	800	400	125x685	1370	750	1,5	1,5	Single	3P	2	1297	619	72,3	332.60	415.80	499.00	582.10	665.30
GN14010030/PD	1400	1000	300	125x885	1370	950	1,5	2	Double	3P	4	-	-	87,6	344.96	431.20	517.44	603.68	689.92
GN14010040	1400	1000	400	125x885	1370	950	1,5	1,5	Single	3P	4	1297	819	93,1	388.10	485.10	582.10	679.00	776.20
GN14010040/PD	1400	1000	400	125x885	1370	950	1,5	2	Double	3P	4	-	-	100,5	388.08	485.10	582.12	679.14	776.16
GN14012040/PD	1400	1200	400	2x(125x485)	370	1150	1,5	2	Double	3P	4	-	-	115,2	443.50	554.40	665.30	776.20	887.00

Single-door cabinets: IP66 / NEMA 1, 4, 12.

Double-door cabinets: IP55 / NEMA 1, 12.

Cold rolled steel primed and painted RAL 7035.

Injected polyurethane sealing gasket.

3P: one 3-point lock.

Cabinets supplied with mounting plate. For references without mounting plate, add /SP; e.g.: GN6012030PD/SP.

Pack of 4 plate height adjusters supplied in all references, even in those without plate /SP.

For references with transparent door, add GNT; e.g.: GNT403015.

Transparent doors from 250x200 to 300x300 mm: 3-mm thick Polycarbonate.

Transparent doors from 300x400 to 1400x1000 mm: 4-mm thick tempered glass.

VDE certificate only available for single-door cabinets.

For special cabinets and cabinets without plate, check availability of UL certificate.

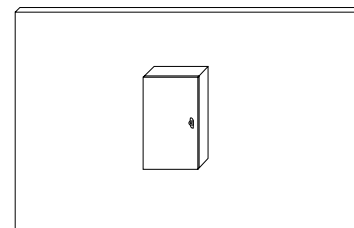



Maximum acceptable loads

	Total load	Door	Plate
Cabinets from 250x200x150 to 300x300x200	150 kg	25 kg	125 kg
Cabinets from 300x400x150 to 400x300x200	175 kg	25 kg	150 kg
Cabinets from 400x400x150 to 600x400x300	225 kg	25 kg	200 kg
Cabinets from 600x500x150 to 700x500x300	275 kg	25 kg	250 kg
Cabinets from 800x400x200 to 800x800x400	325 kg	25 kg	300 kg
Cabinets from 800x1000x300 to 1400x1200x400	390 kg	40 kg	350 kg

Dimensions: Argenta rolled steel

Single door

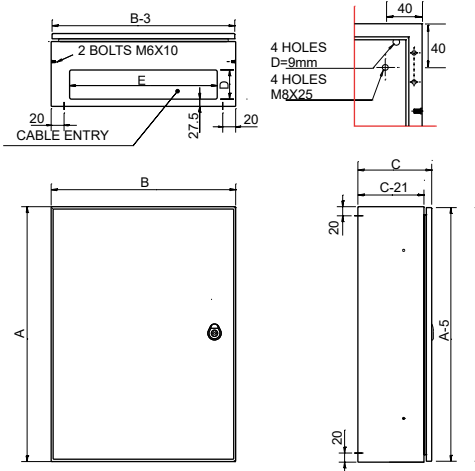

Double door

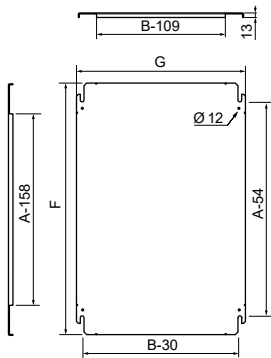
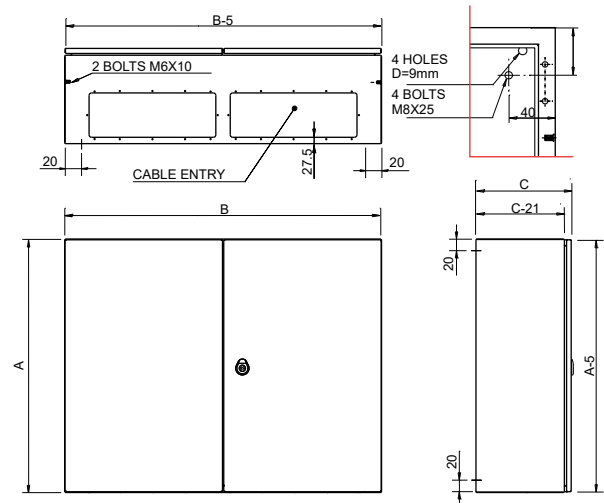

ARGENTA

IP66 rolled steel wall-mounting cabinets

IP54 combinable cabinets. Rolled steel

Reference	Dim. cabinet			Dim. plate		Sheet thickness		No. locks	No. hinges	Reinf. profiles	Weight	Power dissipation according to temperature increase °C P(W)				
	HEIGHT	B	WIDTH	D	E	ENCL.	DOOR					kg	20	25	30	35
GNL605040	600	500	400	570	450	1,5	1,5	3P	2	2	21,2	114.0	142.5	170.9	199.4	227.9
GNL606040	600	600	400	570	550	1,5	1,5	3P	2	2	24,8	129.4	161.7	194.0	226.4	258.7
GNL608040	600	800	400	570	750	1,5	1,5	3P	2	2	32,0	160.2	200.2	240.2	280.3	320.3
GNL6010040	600	1000	400	570	950	1,5	1,5	3P	4	4	40,2	191.0	238.7	286.4	334.2	381.9
GNL6012040	600	1200	400	570	1150	1,5	1,5	3P	4	4	47,3	221.8	277.2	332.6	388.1	443.5

Cold rolled steel primed and painted RAL 7035. Injected polyurethane sealing gasket.

It is not compatible with the assembly of a chassis or inner door.

Cabinets supplied with mounting plate. Pack of 4 plate height adjusters supplied.

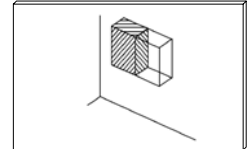

Side panel



Reference

Description

PLA6040

Side panel 600x400 (2 units)

MATERIALS: Cold rolled steel primed and painted RAL 7035.

CHARACTERISTICS: For wall-mounting combinable cabinets.

FOR THE FOLLOWING CABINETS: GNL.

Insulation joint



Reference

Description

48480

Insulation joint (6 m)

MATERIAL: Polyethylene foam.

CHARACTERISTICS: IP55 protection guaranteed.

Dimensions: Argenta combinable

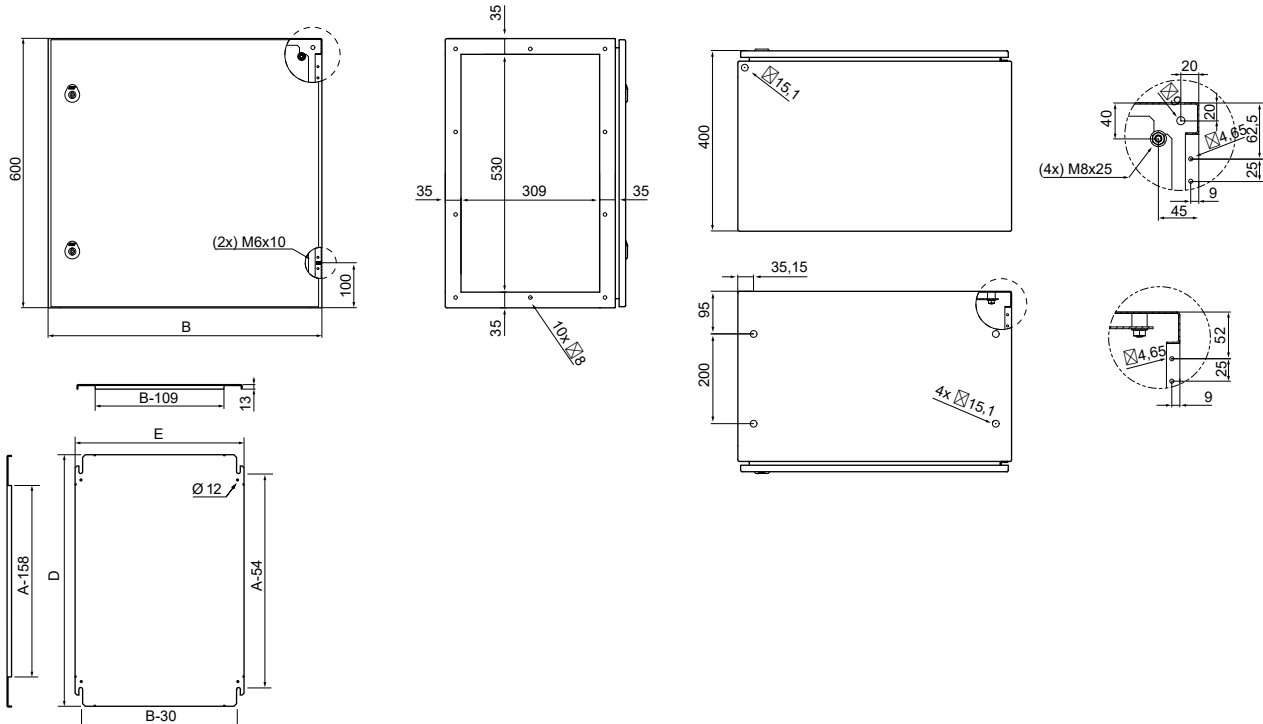

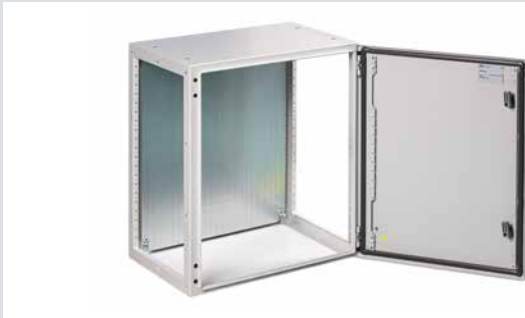

Enclosure

- Made of cold rolled steel, primed and painted RAL 7035.
- Sheet thickness: 1.5 mm.
- Supplied without side panels.
- Four dies in the upper part to install eyebolts. It is necessary to order reference number 48475 as an accessory.
- No cable entry.

Door

- Sheet thickness: 1.5 mm.
- Injected polyurethane sealing gasket.
- Welded reinforcement profiles with cut-out holes with a separation of 25 mm for fitting accessories.



Side panels

- Side panels: Supplied as an accessory, reference PLA6040, including two panels.
- Made of cold rolled steel primed and painted RAL 7035.
- Injected polyurethane sealing gasket.
- M6 countersunk screws for attachment.

Union of cabinets

- The cabinets are joined using 10 M6 screws and nuts, included.
- To achieve an IP54 degree of protection it is necessary to join the cabinets using the sealing gasket reference No. 48480 (see page 144).

Mounting plate

- Flat mounting plate included in all cabinet references.
- Made from galvanised sheet steel with a thickness of 2 mm.

Locking

- Standard 5-mm double-bit lock plus key.
- Other types of locks supplied as accessories.



IDE ELECTRIC

Head office

Leonardo da Vinci 2
Pol. Ind. Los Huertos
E-50800 Zuera (Zaragoza)
SPAIN

Warehouse and logistics

Guttemberg 48
Pol. Ind. Los Huertos
E-50800 Zuera (Zaragoza)
SPAIN

Phone: +34 976 451 080

E-mail: ide@ide.es

Web: www.ide.es

