



GLASS

IP66-IP55 Polyester wall-mounting cabinets

This series is comprised of a set of cabinets made of hot-pressed polyester reinforced with halogen-free fibreglass that deliver a really high level of performance.

With IP66-IP55 protection, they are designed especially for the food, chemical and pharmaceutical industries and outdoor processing centres due to their durability and resistance to chemical agents.



GLASS Technical specifications

- **Degree of protection:**
 - Cabinets from a height of 300 mm to 800 mm: IP66.
 - Cabinets from a height of 500 mm to 1250 mm: IP55.
- **Resistance to impact:**
 - Opaque door: IK10.
 - Transparent door: IK08.
- **Ambient temperature range:** -50 °C / +90 °C.
- **Test of resistance to glow wire:** 960 °C.
- **Thermal class:** A 150 °C.

GLASS Certifications



Compliant with the Low Voltage Directive 2014/35/EU.
Standards: UNE-EN 62208 and UNE-EN 61439-1-3 (as applicable).

GLASS

IP66-IP55 polyester wall-mounting cabinets



Material

Fibreglass-reinforced hot-pressed polyester.

Main characteristics:

- Halogen-free.
- Non-hygroscopic (zero water absorption).
- Double insulation.
- Corrosion-resistant.

Polyester finish

RAL 7035 grey.

Product series

Standard

- IP66 cabinets with opaque and transparent door:
Height: 300 - 400 - 500 - 600 - 800 mm.
Width: 250 - 300 - 400 - 500 - 600 mm.
Depth: 140 - 200 - 230 - 300 mm.
- IP55 cabinets with opaque door.
IP55 cabinets open at the bottom.
- IP55 cabinets with canopy.
Height: 500 - 750 - 1000 - 1250 mm.
Width: 500 - 750 - 1000 - 1250 mm.
Depth: 300 - 420 mm.

Cabinets supplied without mounting plate.

To order

- Special cabinets, dimensions, cut-outs, colours, etc.

Supply

IP66 cabinets (from a height of 300 mm to 800 mm)

- Supplied in individual packaging.
- The accessories for fitting the mounting plate are fitted on the cabinet. Plate supplied in individual packaging if requested as an accessory.
- Key and assembly instructions.

IP55 cabinets (from a height of 500 mm to 1250 mm)

- Supplied individually shrink-wrapped and protected with cardboard at top and bottom.
- The accessories for fitting the mounting plate are fitted on the cabinet. Plate supplied in individual packaging if requested as an accessory.
- Key and assembly instructions.

Recommended applications

Industrial environments and outdoor facilities, food, chemical and pharmaceutical industries, transformer sub-stations and outdoor areas where durability and resistance against chemicals and UV rays are necessary.



IP66 cabinets with transparent door



IP55 cabinets with bottom opening



IP55 cabinets with canopy



Body

IP66 cabinets (from a height of 300 mm to 800 mm)

- Compact body with plain walls, thus optimising space and resistance.
- Lid that guarantees 180° door opening in flush-fit installations, preventing water from entering when the door is opened and guaranteeing flush installation with the surface.
- Quick-fixture guides for M6 screws for fitting accessories without having to drill holes.
- Wall-mounting with head-insulated screws or adjustable brackets (supplied as accessories).

IP55 cabinets (from a height of 500 mm to 1250 mm)

- Top-locking modules with flat lid.
- Two depths available, 300 mm and 420 mm, to cover all requirements.
- They are also available open at the bottom and with canopy.
- Two fixing possibilities by means of brackets made of galvanised steel or plinth (supplied as accessories).

Door

IP66 cabinets (from a height of 300 mm to 800 mm)

- Possibility of opaque or transparent door with 180° opening.
- Opaque doors: Permits the installation of switchgear on the inside. They feature vertical jigs to facilitate machining and to guarantee proper switchgear placement.
- Transparent doors: When combined with a chassis mounting plate and/or inner door they allow you to see the status of the switchgear, while still maintaining IP.
- Internal hinges made of Zamak.

IP55 cabinets (from a height of 500 mm to 1250 mm)

- Available with opaque door.
- Inner hinges that permit 105° opening and the possibility of left or right opening.
- Outer hinges that permit 180° opening and tool-free door disassembly.



Locks

IP66 cabinets (from a height of 300 mm to 800 mm)

- Standard double-bit 3-mm DIN lock.
- Different locking and interlocking systems supplied as accessories.

IP55 cabinets (from a height of 500 mm to 1250 mm)

- Standard 3-mm, 3-point double-bit insert lock with retractable handle.
- Other types of locks supplied as accessories.

Mounting plate

IP66 cabinets (from a height of 300 mm to 800 mm)

- Mounting plates available:
 - 4-mm thick polyester.
 - 2-mm thick galvanised steel sheet.
 - 4-mm thick insulating Bakelite.
- Plate adjustment pack available for depths 200, 230 and 300 mm.
- Mounting plates supplied as accessory.

IP55 cabinets (from a height of 500 mm to 1250 mm)

- Mounting plates available:
 - 4-mm thick polyester.
 - 2 and 3-mm thick galvanised metal.
- Plate adjustment pack available for both depths, 300 and 420 mm.
- Mounting plates supplied as accessory.

GLASS

IP66 polyester wall-mounting cabinets

Opaque single-door cabinets. IP66 Polyester

Reference No.	Dimensions (AXBXC)	Polyester thickness		No. locks	No. hinges	Wall-mounting (EXF)	Weight KG	Power dissipation according to temperature increase °C P(W)*				
		BODY	LID					20	25	30	35	40
POL302514	300x250x140	2.5	2.7	1	2	248x215	2.20	16.1	20.1	24.1	28.1	32.1
POL403020	400x300x200	2.8	2.8	2	2	338x262	3.65	27.7	34.7	41.6	48.5	55.4
POL404020	400x400x200	2.8	2.8	2	2	338x362	4.55	33.6	42.0	50.4	58.8	67.2
POL504020	500x400x200	2.8	2.8	2	2	438x362	5.42	40.0	50.1	60.1	70.1	80.1
POL604023	600x400x230	3	3	2	2	538x362	7.61	49.9	62.4	74.9	87.4	99.8
POL605023	600x500x230	3	3	2	2	538x462	8.33	58.1	72.6	87.1	101.6	116.1
POL806030	800x600x300	3	3	2	2	734x558	12.99	94.9	118.7	142.4	166.1	189.8

Polyester RAL 7035.

Cabinets supplied without mounting plate.

With 1/4 turn lock.

Transparent single-door cabinets. IP66 Polyester

Reference No.	Dimensions (AXBXC)	Polyester thickness		No. locks	No. hinges	Door with transparent panel (KXJ)	Wall-mounting (EXF)	Weight KG	Power dissipation according to temperature increase °C P(W)*				
		BODY	LID						20	25	30	35	40
POL302514PT	300x250x140	2.5	2.7	1	2	220x115	248x215	1.25	16.1	20.1	24.1	28.1	32.1
POL403020PT	400x300x200	2.8	2.8	2	2	281x121	338x262	3.25	27.7	34.7	41.6	48.5	55.4
POL404020PT	400x400x200	2.8	2.8	2	2	281x221	338x362	4.00	33.6	42.0	50.4	58.8	67.2
POL504020PT	500x400x200	2.8	2.8	2	2	381x221	438x362	5.00	40.0	50.1	60.1	70.1	80.1
POL604023PT	600x400x230	3	3	2	2	481x221	538x362	7.00	49.9	62.4	74.9	87.4	99.8
POL605023PT	600x500x230	3	3	2	2	481x321	538x462	7.50	58.1	72.6	87.1	101.6	116.1
POL806030PT	800x600x300	3	3	2	2	681x421	734x558	11.92	94.9	118.7	142.4	166.1	189.8

Polyester RAL 7035.

Cabinets supplied without mounting plate.

With 1/4 turn lock.

* Calculations obtained according to the CEI 890:1997 standard + Corrigendum 1998; "Method of temperature-rise assessment by extrapolation for partially type-tested assemblies (PTTA) of low-voltage switchgear and control gear".

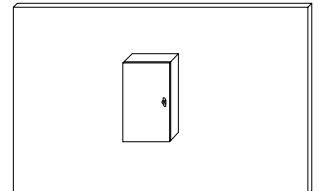



IP66 polyester cabinet
with opaque door



IP66 polyester cabinet
with transparent door



Maximum acceptable loads

IP66	Total Load	Door	Plate
300x250x140 cabinets	16.25 Kg	2.25 Kg	14 Kg
400x300x200 cabinets	26.60 Kg	3.60 Kg	23 Kg
400x400x200 cabinets	34.80 Kg	4.80 Kg	30 Kg
500x400x200 cabinets	44.00 Kg	6.00 Kg	38 Kg
600x400x230 cabinets	52.20 Kg	7.20 Kg	45 Kg
600x500x230 cabinets	65.00 Kg	9.00 Kg	56 Kg
800x600x300 cabinets	104.40 Kg	14.40 Kg	90 Kg

Dimensions: IP66 Polyester

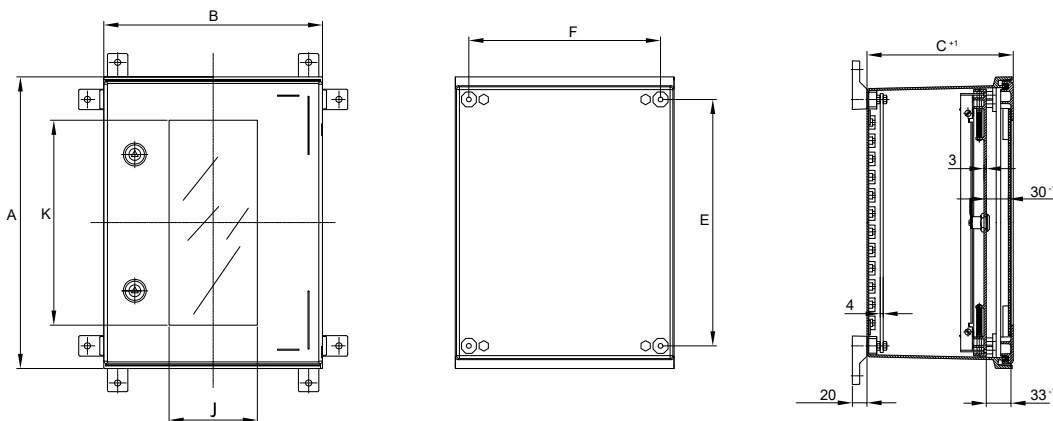

Opaque-door cabinets. IP55 Polyester

Reference No.	Dimensions (AXBXC)	Polyester thickness			No. locks	No. hinges	Wall-mounting	Weight KG	Power dissipation according to temperature increase °C P(W)**				
		BODY SIDES	BODY TOP/ BOTTOM	BODY REAR DOOR					20	25	30	35	40
POL505030	510x500x312	4	3	3.5	3P	2	368x552	12.50	60.3	75.4	90.5	105.6	120.7
POL755030	760x500x312	4	3	3.5	3P	2	618x552	17.50	82.4	103.0	123.6	144.2	164.8
POL1005030	1010x500x312	4	3	3.5	3P	3	868x552	21.80	104.5	130.6	156.7	182.8	209.0
POL1007530	1010x750x312	4	3	3.5	3P	3	868x802	25.70	136.9	171.1	205.3	239.5	273.7
POL1007542	1010x750x420	3	3	3.5	3P	3	868x802	29.60	161.0	201.2	241.4	281.7	321.9
POL10010030(*)	1010x1000x312	4	3	3.5	3P/3P	3/3	868x1052	30.60	150.0	199.0	249.0	302.0	357.0
POL10010042(*)	1010x1000x420	3	3	3.5	3P/3P	3/3	868x1052	38.00	181.0	239.0	300.0	364.0	430.0
POL1255030	1260x500x312	4	3	3.5	3P	4	1118x552	26.50	126.6	158.2	189.8	221.5	253.1
POL1257530	1260x750x312	4	3	3.5	3P	4	1118x802	29.50	165.1	206.3	247.6	288.9	330.2
POL1257542	1260x750x420	3	3	3.5	3P	4	1118x802	33.50	192.9	241.2	289.4	337.7	385.9
POL12510030(*)	1260x1000x312	4	3	3.5	3P/3P	4/4	1118x1052	38.80	166.0	220.0	275.0	334.0	395.0
POL12510042(*)	1260x1000x420	3	3	3.5	3P/3P	4/4	1118x1052	44.15	205.0	271.0	341.0	413.0	488.0
POL12512530(*)	1260x1250x312	4	3	3.5	3P/3P	4/4	1118x1302	44.90	230.0	305.0	383.0	463.0	547.0
POL12512542(*)	1260x1250x420	3	3	3.5	3P/3P	4/4	1118x1302	50.50	278.0	367.0	461.0	559.0	660.0

(*) Double-door cabinets.

Opaque-door cabinets. IP55 Polyester open at the bottom

Reference No.	Dimensions (AXBXC)	Polyester thickness			No. locks	No. hinges	Wall-mounting	Weight KG	Power dissipation according to temperature increase °C P(W)**				
		BODY SIDES	BODY TOP/ BOTTOM	BODY REAR DOOR					20	25	30	35	40
POL505030/A	510x500x312	4	3	3.5	3P	2	368x552	12.00	60.3	75.4	90.5	105.6	120.7
POL755030/A	760x500x312	4	3	3.5	3P	2	618x552	17.00	82.4	103.0	123.6	144.2	164.8
POL1005030/A	1010x500x312	4	3	3.5	3P	3	868x552	23.30	104.5	130.6	156.7	182.8	209.0
POL1007530/A	1010x750x312	4	3	3.5	3P	3	868x802	25.00	136.9	171.1	205.3	239.5	273.7
POL1007542/A	1010x750x420	3	3	3.5	3P	3	868x802	28.75	161.0	201.2	241.4	281.7	321.9
POL10010030/A(*)	1010x1000x312	4	3	3.5	3P/3P	3/3	868x1052	30.60	150.0	199.0	249.0	302.0	357.0
POL10010042/A(*)	1010x1000x420	3	3	3.5	3P/3P	3/3	868x1052	38.00	181.0	239.0	300.0	364.0	430.0
POL1255030/A	1260x500x312	4	3	3.5	3P	4	1118x552	26.00	126.6	158.2	189.8	221.5	253.1
POL1257530/A	1260x750x312	4	3	3.5	3P	4	1118x802	28.80	165.1	206.3	247.6	288.9	330.2
POL1257542/A	1260x750x420	3	3	3.5	3P	4	1118x802	32.65	192.9	241.2	289.4	337.7	385.9
POL12510030/A(*)	1260x1000x312	4	3	3.5	3P/3P	4/4	1118x1052	38.80	166.0	220.0	275.0	334.0	395.0
POL12510042/A(*)	1260x1000x420	3	3	3.5	3P/3P	4/4	1118x1052	44.15	205.0	271.0	341.0	413.0	488.0
POL12512530/A(*)	1260x1250x312	4	3	3.5	3P/3P	4/4	1118x1302	44.90	230.0	305.0	383.0	463.0	547.0
POL12512542/A(*)	1260x1250x420	3	3	3.5	3P/3P	4/4	1118x1302	50.50	278.0	367.0	461.0	559.0	660.0

Polyester RAL 7035.

Cabinets supplied without mounting plate.

Opaque door cabinets with retractable handle.

3P: one 3-point lock.

(*) Double-door cabinets.

Check availability of cabinets opened at the bottom and with canopy (not in stock).



IP55 polyester cabinet with opaque door



IP55 polyester cabinet open at the bottom



IP55 polyester cabinet with canopy

Opaque-door cabinets. IP55 Polyester with canopy

Reference No.	Dimensions (AXBXC)	Polyester thickness				No. locks	No. hinges	Wall-mounting	Weight KG	Power dissipation according to temperature increase °C P(W)**				
		BODY SIDES	BODYTOP/ BOTTOM	BODY REAR DOOR	CANOPY					20	25	30	35	40
POL505030/T	510x500x312	4	3	3.5	4	3P	2	368x552	14.50	60.3	75.4	90.5	105.6	120.7
POL755030/T	760x500x312	4	3	3.5	4	3P	2	618x552	19.50	82.4	103.0	123.6	144.2	164.8
POL1005030/T	1010x500x312	4	3	3.5	4	3P	3	868x552	23.80	104.5	130.6	156.7	182.8	209.0
POL1007530/T	1010x750x312	4	3	3.5	4	3P	3	868x802	28.40	136.9	171.1	205.3	239.5	273.7
POL1007542/T	1010x750x420	3	3	3.5	3	3P	3	868x802	32.60	161.0	201.2	241.4	281.7	321.9
POL10010030/T(*)	1010x1000x312	4	3	3.5	3	3P/3P	3/3	868x1052	33.50	150.0	199.0	249.0	302.0	357.0
POL10010042/T(*)	1010x1000x420	3	3	3.5	3.5	3P/3P	3/3	868x1052	41.45	181.0	239.0	300.0	364.0	430.0
POL1255030/T	1260x500x312	4	3	3.5	4	3P	4	1118x552	28.50	126.6	158.2	189.8	221.5	253.1
POL1257530/T	1260x750x312	4	3	3.5	4	3P	4	1118x802	32.20	165.1	206.3	247.6	288.9	330.2
POL1257542/T	1260x750x420	3	3	3.5	3	3P	4	1118x802	36.50	192.9	241.2	289.4	337.7	385.9
POL12510030/T(*)	1260x1000x312	4	3	3.5	3	3P/3P	4/4	1118x1052	41.70	166.0	220.0	275.0	334.0	395.0
POL12510042/T(*)	1260x1000x420	3	3	3.5	3.5	3P/3P	4/4	1118x1052	47.60	205.0	271.0	341.0	413.0	488.0
POL12512530/T(*)	1260x1250x312	4	3	3.5	3	3P/3P	4/4	1118x1302	48.40	230.0	305.0	383.0	463.0	547.0
POL12512542/T(*)	1260x1250x420	3	3	3.5	3.5	3P/3P	4/4	1118x1302	54.40	278.0	367.0	461.0	559.0	660.0

Polyester RAL 7035.

Cabinets supplied without mounting plate.

Opaque door cabinets with retractable handle.

3P: one 3-point lock.

(*) Double-door cabinets.

Check availability of cabinets opened at the bottom and with canopy (not in stock).

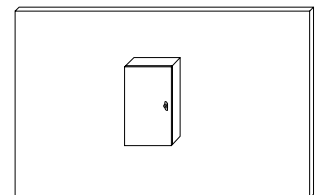

** Calculations obtained according to the CEI 890:1997 standard + Corrigendum 1998; "Method of temperature-rise assessment by extrapolation for partially type-tested assemblies (PTTA) of low-voltage switchgear and control gear".

Maximum acceptable loads

IP55	Total Load	Door	Plate
510x500x312	58 Kg	8 Kg	50 Kg
760x500x312	76.5 Kg	10.5 Kg	66 Kg
1010x500x312	102 Kg	14 Kg	88 Kg
1010x750x312	152 Kg	21 Kg	131 Kg
1010x750x420	152 Kg	21 Kg	131 Kg
1010x1000x312	182 Kg	21 Kg	161 Kg
1010x1000x420	182 Kg	21 Kg	161 Kg

IP55	Total Load	Door	Plate
1260x500x312	127 Kg	17.5 Kg	109 Kg
1260x750x312	190 Kg	26 Kg	164 Kg
1260x750x420	190 Kg	26 Kg	164 Kg
1260x1000x312	126.5/126.5 Kg	17.5/17.5 Kg	109/109 Kg
1260x1000x420	126.5/126.5 Kg	17.5/17.5 Kg	109/109 Kg
1260x1250x312	126.5/190 Kg	17.5/26 Kg	109/164 Kg
1260x1250x420	126.5/190 Kg	17.5/26 Kg	109/164 Kg

Dimensions: IP55 Polyester

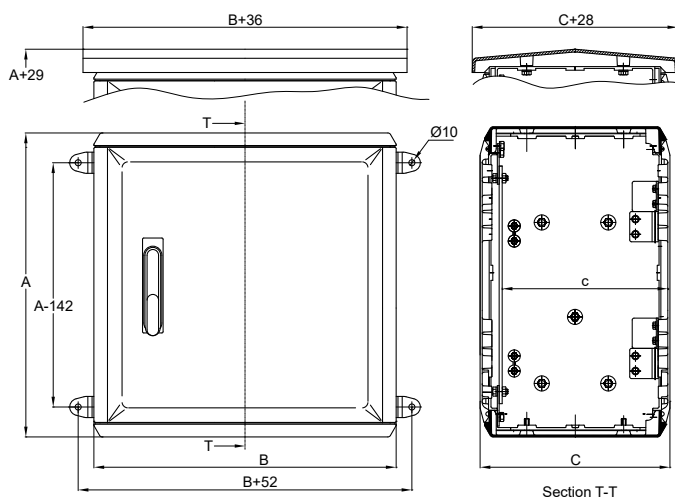

Wall-hanging accessories not included in the set.



Head Office

Leonardo da Vinci 2
Pol. Ind. Los Huertos
E-50800 Zuera
Zaragoza (Spain)

Warehouse and logistics

Guttemberg 48
Pol. Ind. Los Huertos
E-50800 Zuera
Zaragoza (Spain)

Phone: +34 976 451 080**E-mail:** ide@ide.es**Web:** www.ide.es

